



INSTALLATION GUIDE

安装说明书

This installation guide is applicable for all ICEWING 5 and KILLER WHALE series.
此说明书适用于九州风神冰翼5和黑虎鲸系列产品。

CAUTION:

1. All specifications subject to change without notice.
2. Under no condition shall Deepcool be liable for any indirect, incidental or consequential damages arising from any defect or error in this manual or product.
3. Please ask for professional help if you are not sure of safe installation.
4. Installation manual in other languages is available on our website: www.deepcoolglobal.com.

警告声明:

1. 本公司有权在未事先通知的情况下对本说明书进行修改，以便改进产品的稳定性、设计及功能。
2. 本说明书之描述内容不代表本公司之承诺，对于任何因安装或使用不当而造成直接、间接、有意、无意的损坏及隐患，本公司概不负责。
3. 在无法掌握操作方法前需请求专业人士帮助，严禁在未掌握操作要领的前提下使用本产品。
4. 若需对本公司产品了解更多信息，请浏览我们的网页：www.deepcoolglobal.com

Beijing Deepcool Industries Co., Ltd.
<http://www.deepcoolglobal.com>

MADE IN CHINA

出品:北京市九州风神科贸有限责任公司
地址:北京市中关村科技园区

COMPONENTS LIST 零部件说明

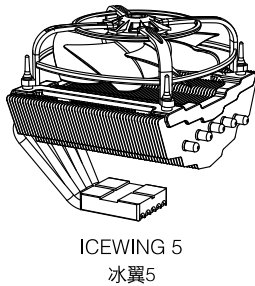

ICEWING 5
冰翼5

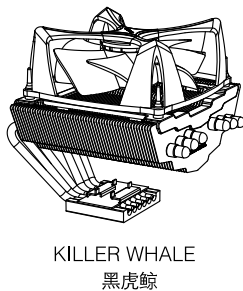

KILLER WHALE
黑虎鲸

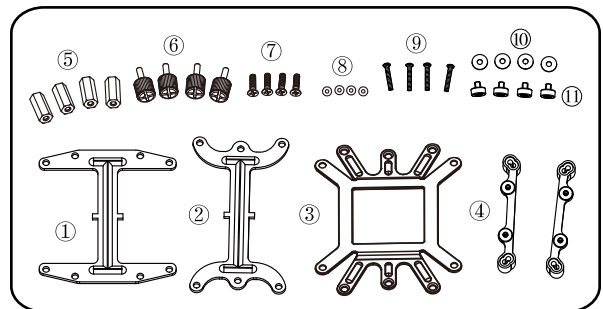

1) Retention Plate(Intel)	工型扣具UI	1PC
2) Retention Plate(AMD)	工型扣具UA	1PC
3) Back Plate	背板	1PC
4) LGA1366/1156 Retention Bracket	1366/1156转接架	2PCS
5) Hex-head Nut	六角螺母	4PCS
6) Thumb Screw	螺丝A	4PCS
7) Flat Screw	十字螺钉	4PCS
8) Washer	垫片A	4PCS
9) Panhead Screw	长十字螺钉	4PCS
10) Insulating Washer	绝缘胶垫	4PCS
11) LGA1366/1156 Rivet Nut	背铆钉	4PCS

产品示意图
PRODUCT SCHEMATIC DRAWING

INTEL LGA775 Installation 安装步骤

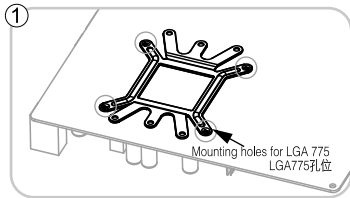

Put the back plate onto the back of the motherboard and insert the flat screws through the LGA775 mounting holes.
如图所示，放好背板，将十字螺丝穿过背板对应的LGA775孔位。

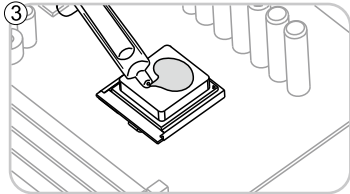

Evenly apply a thin layer of thermal grease onto the processor.
将导热膏均匀涂在CPU表面。

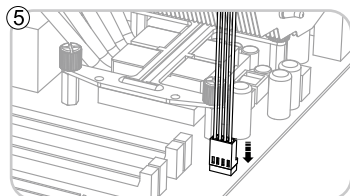

Finish the installation by connecting the fan cable to the motherboard.
将风扇插头插在主板相应位置，确认无误后完成安装。

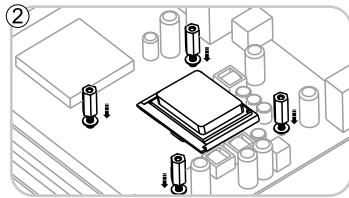

Slip the washers on the flat screws protruding out of the motherboard, and thread the hex-head nuts on the screws to secure the back plate.
将垫片A装置穿过主板的十字螺钉上，然后用六角螺母锁紧背板。

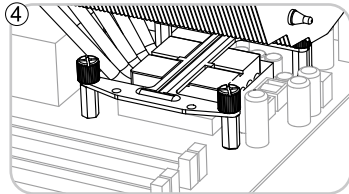

Put the heatsink onto the processor, and put the retention plate(Intel) across the heatsink base, then secure the heatsink by threading the thumb screws into the hex-head nuts.
将散热器放在CPU上，注意底部与CPU表面完全解除，然后放入工型扣具UI，使其LGA775孔位与六角螺母对齐，将螺母A穿过工型扣具，锁入六角螺母，用手拧紧。

INTEL LGA1366/1156 Installation 安装步骤

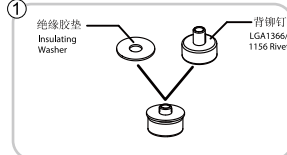

Peel off the film of insulating washer from one side and stick it onto the LGA1366/1156 rivets.
撕开绝缘胶垫一面胶纸，贴纸背铆钉上面。

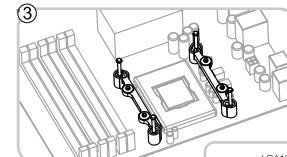

Fasten the LGA1366/1156 retention brackets onto the motherboard by threading panhead screws into the LGA1366/1156 rivets.
将转接架对准背铆钉，如图放置，用长十字螺钉将转接架锁紧在主板。小图为转接架对应架构的孔位。

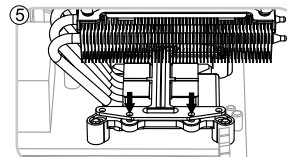

Put the heatsink onto the processor, and put the retention plate(Intel) across the heatsink base, then secure the heatsink by threading the thumb screws into the hex-head nuts.
将散热器放在CPU上，注意底部与CPU表面完全解除，然后放入工型扣具UI，使其箭头所指孔位对准转接架铆钉。

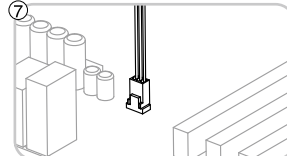

Finish the installation by connecting the fan cable to the motherboard.
将风扇插头插在主板相应位置，确认无误后完成安装。

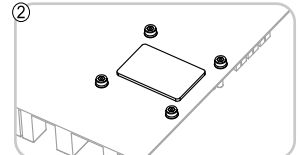

Peel off the other film of insulation washers, stick them onto the back of the motherboard.
撕开绝缘胶垫另一面胶纸，将背铆钉对准主板孔位放置，压紧。

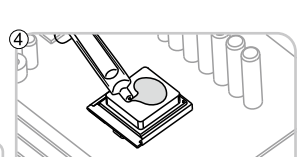

Evenly apply a thin layer of thermal grease onto the processor.
将导热膏均匀涂在CPU表面。

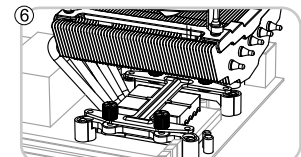

Secure the heatsink by threading the thumb screws into the retention bracket.
用螺丝A穿过工型扣具对用孔位，锁入转接架铆钉，用手拧紧。

AMD AM3/ AM2+/AM2 Installation 安装步骤

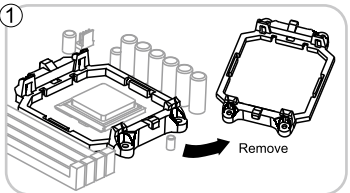

Remove the original retention frame from the motherboard.
将主板上原有塑胶框拆除。

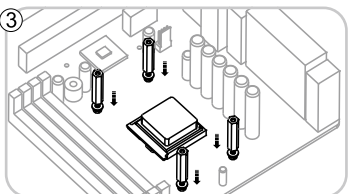

Slip the washers on the flat screws protruding out of the motherboard, and thread the hex-head nuts on the screws to secure the back plate.
将垫片A装置穿过主板的十字螺钉上，然后用六角螺母锁紧背板。

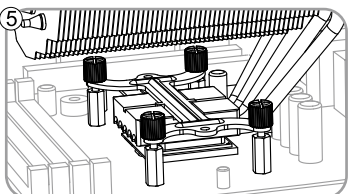

Put the heatsink onto the processor, and put the retention plate(AMD) across the heatsink base, then secure the heatsink by threading the thumb screws into the hex-head nuts.
将散热器放在CPU上，注意底部与CPU表面完全解除，然后放入工型扣具UA，使其AM3/AM2+/AM2孔位与六角螺母对其，将螺母A穿过工型扣具，锁入六角螺母，用手拧紧。

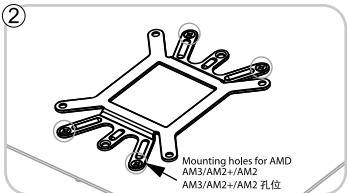

Put the back plate onto the back of the motherboard, insert the flat screws through the AM3/AM2+/AM2 mounting holes as circled.
如图所示，放好背板，将十字螺钉穿过背板对应的AM3/AM2+/AM2孔位。

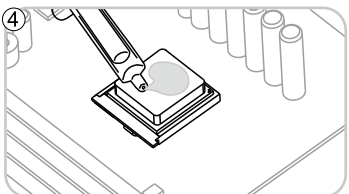

Evenly apply a thin layer of thermal grease onto the processor.
将导热膏均匀涂在CPU表面。

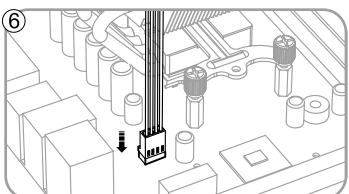

Finish the installation by connecting the fan cable to the motherboard.
将风扇插头插在主板相应位置，确认无误后完成安装。

AMD K8 Installation 安装步骤

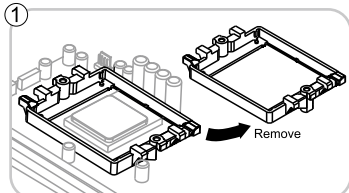

Remove the original retention frame from the motherboard.
将主板上原有塑胶框拆除。

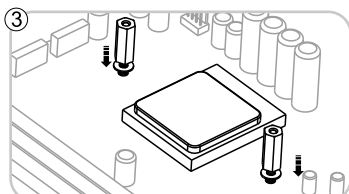

Slip the washers on the flat screws protruding out of the motherboard, and thread the hex-head nuts on the screws to secure the back plate.
将垫片A装置在穿过主板的十字螺钉上，然后用六角螺母锁紧背板。

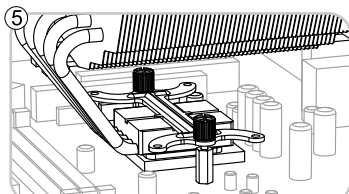

Put the heatsink onto the processor, and put the retention plate(AMD) across the heatsink base, then secure the heatsink by threading the thumb screws into the hex-head nuts.
将散热器放在CPU上，注意底部与CPU表面完全解除，然后放入工型扣具UA，使其K8孔位与六角螺母对其，将螺丝A穿过工型扣具，锁入六角螺母，用手拧紧。

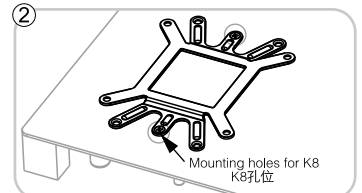

Put the back plate onto the back of the motherboard, insert the flat screws through the AM3/AM2+/AM2 mounting holes as circled.
如图所示，放好背板，将十字螺钉穿过背板对应的AM3/AM2+/AM2孔位。

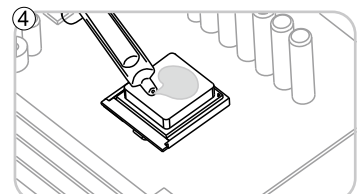

Evenly apply a thin layer of thermal grease onto the processor.
将导热膏均匀涂在CPU表面。

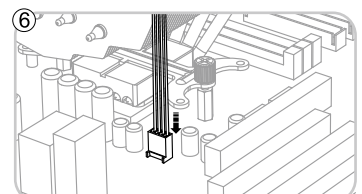

Finish the installation by connecting the fan cable to the motherboard.
将风扇插头插在主板相应位置，确认无误后完成安装。